

HYPERDESMO Car Park waterproofing System

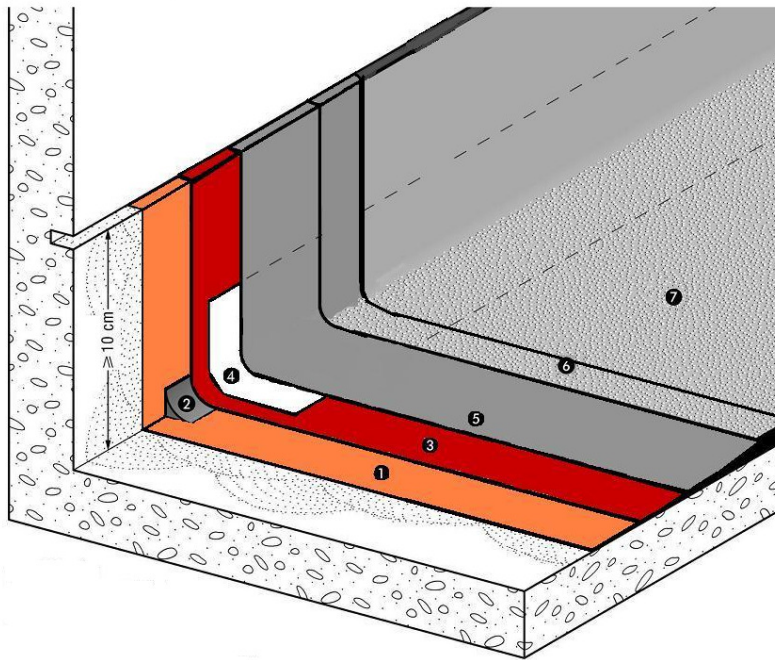

0. Substrates clean and sound

1. Primer:

AQUADUR > 0,150 kg/m² (consumption highly dependant on condition of the substrate) If there is danger of rising negative pressure, and a vapour barrier is recommended then the consumption of AQUADUR is increased to 0.600 Kg/m²

2. Treatment of Inner Angles with PU sealant **HYPERSEAL-25LM**

3. **HYPERDESMO(or LV)** : 1st Coat = 0,75 - 1,00 kg/m² (OPTIONAL:

ACCELERATOR-3000 A 4% by weight may be added in case complete uniform thickness is specified or in case of low temp/humidity in order to quicken the cure profile)

4. Option: Non-Woven Polyester, in inner angles, bonded in the 1st fresh coat of **HYPERDESMO (or LV)**

5. **HYPERDESMO (or LV)** : 2nd Coat = 0,75 - 1,00 kg/m² (OPTIONAL:

ACCELERATOR-3000 4% by weight for uniform thickness and/or in case of low temp/humidity)

6. **HYPERDESMO (OR LV)** : 3d coat 0,300 – 0,350 kg/m² + Neutral dry QUARTZ or Corundum Aggregates at 2 to 3 kg/m² on the fresh 3nd layer of, before the final Coloured Top Coat **HYPERDESMO-ADY- E**

7. Hyperdesmo AD-Y-E final Top Coat in two coats coloured with Alchimica pigment paste: Minimum Consumption 0.2 Kg/m²